

FOR LEASE FISHER BUILDING

10,615 SF | 1222 6th Ave N, Kent, WA



NEWMARK

THAD MALLORY, SIOR

thad.mallory@nmrk.com
425-362-1410

TAYLOR HOFF, SIOR

taylor.hoff@nmrk.com
425-362-1388

BLAKE BENTZ

blake.bentz@nmrk.com
425-362-1391

FOR LEASE

FISHER BUILDING

10,615 SF | 1222 6th Ave N, Kent, WA

SITE PLAN

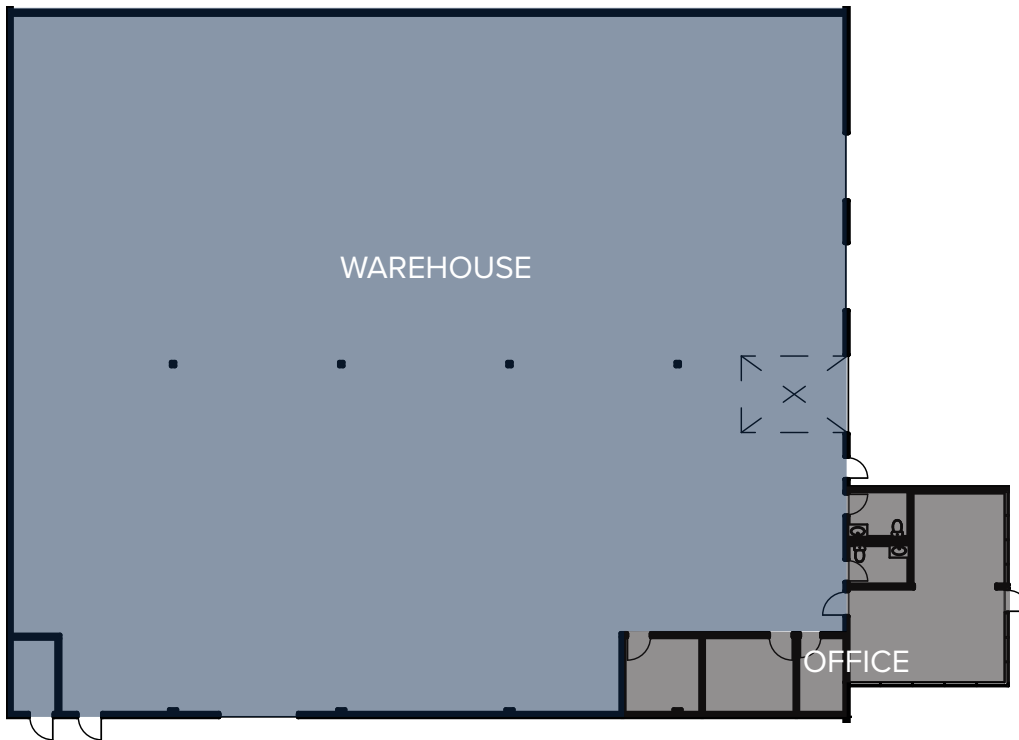

BUILDING DETAILS

ADDRESS

1222 6th Ave N, Kent, WA

BUILDING SF

10,615 SF (760 SF Office)

CLEAR HEIGHT

24'

LOADING

2 Dock High Doors (with edge of dock plates)
2 Grade Level Doors (12'x8' & 14'x8')

PROPERTY HIGHLIGHTS

- LED Lighting in the warehouse
- Existing racking can be available for tenant
- Power: 300 amps of 3-phase 120/208v
- Ample parking
- Premise includes key card access and security system with cameras.
- Rates: \$1.25 shell & \$1.30 office, \$0.377 NNN

FOR LEASE

FISHER BUILDING

10,615 SF | 1222 6th Ave N, Kent, WA



FOR LEASE

FISHER BUILDING

10,615 SF | 1222 6th Ave N, Kent, WA



The information contained herein has been obtained from sources deemed reliable but has not been verified and no guarantee, warranty or representation, either express or implied, is made with respect to such information. Terms of sale or lease and availability are subject to change or withdrawal without notice.